

KLP+ TRAP ASSEMBLY INSTRUCTIONS

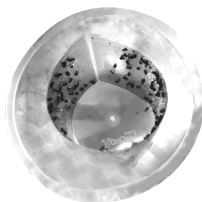

Each trap comes with a sticky insert.

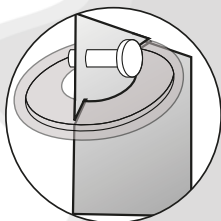

Place the attractant in the opening provided for this purpose in the yellow card.

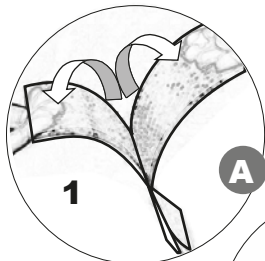

1

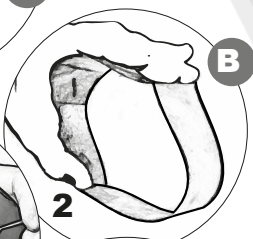

2-4

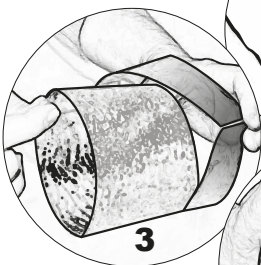

3

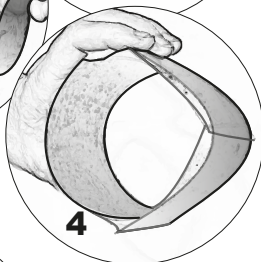

4

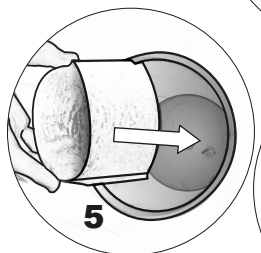

5

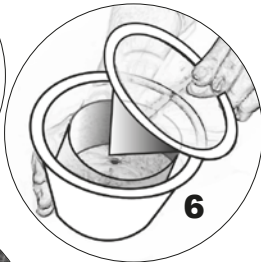

6

How to assemble sticky insert:

- 1 Separate one sticky insert (A) from the pair of inserts.
- 2-4 Place sticky insert into the holder ring (B), so that the sticky side faces in.
- 5 Put the assembled cylindrical sticky insert into the catch container of the trap.
- 6 Place the plastic funnel in catch container and assemble trap.

**For more information about our products, contact us or visit www.solida.ca.*



solida.ca

info@solida.ca

418-826-0900